

AGC of Wisconsin 2009-2010 Building Information Modeling (BIM)

Your Resource for Successful BIM Implementation

AGC's BIM Education is comprised of six units. The program is designed to give participants a broad understanding and essential knowledge on BIM terminology, technology, concepts, functionality, and legal and insurance issues.

Unit 1: BIM 101: An Introduction to Building Information Modeling

What is BIM?

BIM Visualization Uses and Spatial Coordination

BIM Scheduling, Estimating and Facility Management

Getting Started with BIM

Unit 2: BIM Technology

Phases of a BIM Project

Classes of BIM Technology

Specific BIM Applications

Need for Planning/Organizing to Use BIM Tools

Requirement to Embed Tools Into Process

Process for Selecting Relevant BIM Tools

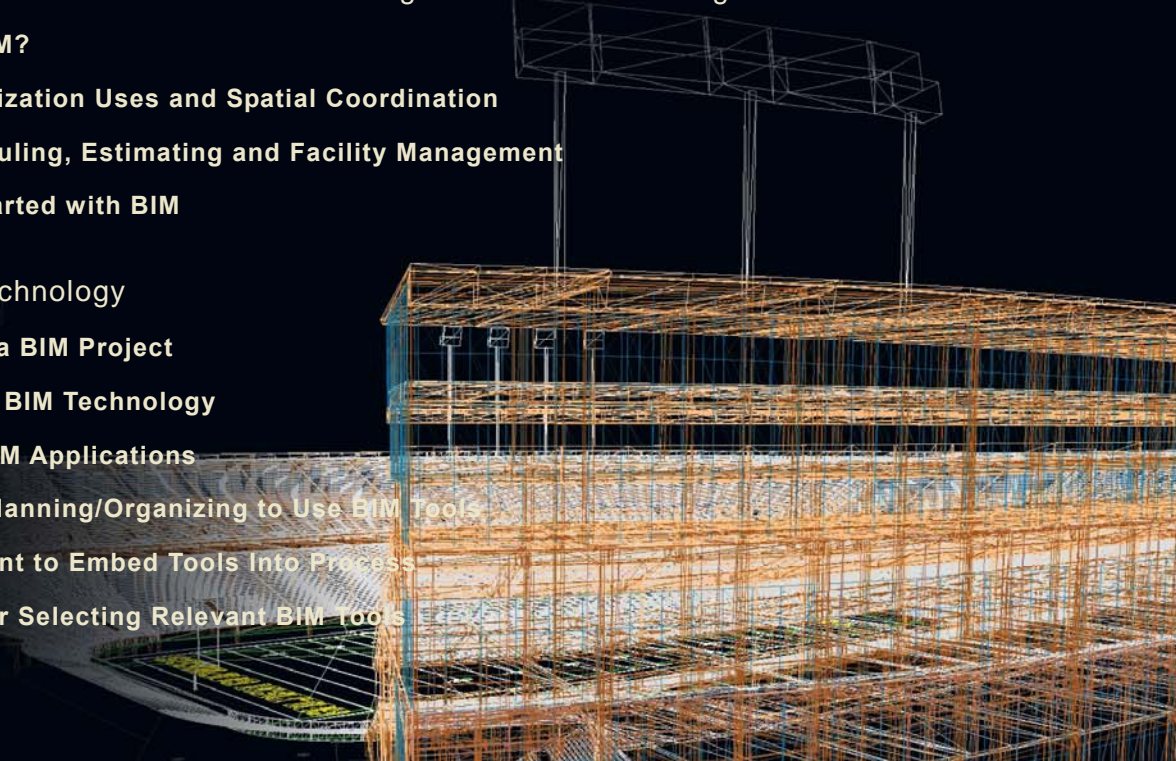

Instructor: David Webster
Application Engineer - Building Industry

David is an Application Engineer with MasterGraphics, specializing in the A/E/C industry. with 20 years of experience as a CAD standards manager, David has an Associate's Degree in Architectural Engineering Technology from Wentworth Institute of Technology in Boston, MA

For more information

www.agcwi.org/events calendar
1-800-362-8022

BIM 101 courses are offered in three locations in Wisconsin (Madison, Appleton and Racine).

UNIT 1

BIM 101: AN INTRODUCTION TO BUILDING INFORMATION MODELING

BIM 101: An Introduction to Building Information Modeling

BIM 101 is designed specifically for construction professionals eager to learn the essential concepts of BIM. Those who will also benefit include building developers, owners, managers, supervisors, architects, engineers, and construction product manufacturers. Students in the architecture, engineering and construction industry will also greatly benefit from this training.

The full-day course will give participants a comprehensive overview of BIM, supported by case studies to help participants comprehend each session's learning objectives. BIM 101 will introduce important concepts that will be necessary for future BIM courses.

Session 1—What Is BIM?

- Define common BIM terminology and BIM-related components
- Recognize differences between 2D CAD and 3D BIM
- Describe the evolution of BIM (past, present and future)
- Discuss how BIM is used in collaboration
- Discuss the benefits of BIM to all parties involved

Session 2—BIM Visualization Uses and Spatial Coordination

- Recognize the basics of the modeling process and model management protocol
- Recognize BIM uses in visualization, value analysis and scope clarification
- Explain the advantages of BIM in regards to spatial coordination

Session 3—BIM Scheduling, Estimating and Facility Management

- Recognize the advantages of BIM in scheduling and estimating
- Recognize how companies are using BIM in facility management
- Explain the benefits to and lessons learned from companies using BIM

Session 4—Getting Started with BIM

- Identify challenges for getting started with BIM
- Demonstrate a basic understanding of BIM tools
- Develop a BIM Action Plan
- Use BIM resources provided to further understanding of more advanced BIM concepts and practice

This unit requires eight hours of classroom instruction.

Madison: October 6, 2009 (Location TBD) CODE: BIM 2009-1M

Appleton: October 20, 2009 (Location TBD) CODE: BIM 2009—1A

Racine: November 5, 2009 (Location TBD) CODE BIM 2009-1R

UNIT 2 BIM TECHNOLOGY

BIM Technology

Building Information Modeling (BIM) is one of the most exciting developments in the construction industry and is changing the way projects are built. Join your peers for this two-part course, providing construction industry stakeholders relevant tools and information necessary to implement BIM software and processes.

Session 1: BIM Technology, Process, Capabilities, and Tools

Following this session, participants will have the ability to:

- Identify at least five benefits of the BIM approach
- Explain what is meant by parametric modeling and why this benefits the BIM process
- Distinguish between a traditional "silo-building approach and a BIM collaborative open-ended approach
- Associate each class of BIM tools with the appropriate project lifecycle phase
- Match specific BIM tools with their function
- Determine which tools support your project phases and decide if each tool supports the process

Session 2: BIM Interoperability

Following this session, participants will have the ability to:

- Recognize the process of integration of a single BIM application with multiple others
- Differentiate ways to model and describe why coordination is important: coordinate systems, object naming, ownership and object management, version management
- Identify methods of data exchange
- Recognize why object exchange is difficult; varying parametric rule sets, issues of attributes

Following this course, participants will be provided a listing of resources for contact for hands-on software training through software firms to achieve the next level of competency in BIM technology.

This unit requires two sessions of classroom instruction

Madison (Location TBD): February 23-24 CODE: BIM 2009-2M

Appleton (Location TBD): March 23-24 CODE: BIM 2009-2A

Racine (Location TBD): April 27-28 CODE: BIM 2009-2R

Register for both units and SAVE!

REGISTRATION FORM

SESSION TIME: All sessions will be held from 8 a.m. until 5 p.m. with a 1 hour lunch (provided)

LOCATION:

MADISON (October 6, February 23-24): TBD

APPLETON (October 20, March 23-24): TBD

RACINE (November 5, April 20-21): TBD

FEE: (Unit 1/Unit 2/Both).....Register for Both Units and Save! Circle option below

AGC Members: \$250/ \$325/ \$500

Partners: \$375/ \$575/ \$900

Non-Members: \$500/ \$650/ \$1100

REGISTRATION & REFUND DEADLINE:

Registration and refund deadline is one week prior to the seminar.

****Participants registered for both units may attend missed session in a different location.**

Registration Form

Seminar Code: _____

Company Name: _____

Attendee Name: _____

Address: _____

Phone: _____

Fax: _____

Attendee E-Mail: _____

Payment Information

Check made payable to AGC of Wisconsin

Bill Me (AGC Members Only)

Visa/Mastercard

Account Number: _____ Exp Date: _____

Name as shown on card: _____

Signature: _____

Mail or fax registration to 608-221-4446

4814 E Broadway ~ Madison, WI 53715

Questions? Contact the AGC of Wisconsin at 1-800-362-8022